

| PIPE | FLANGE DATA | | | HUB DATA | | FLANGE FACING | | DRILLING DATA | | | WEIGHT |
|-------------------|------------------|-----------|--------------------|----------|----------|--------------------|---------------|-----------------|--------------------|-------------------------|------------|
| Nominal pipe size | Outside diameter | Thickness | Length through hub | Radius | Diameter | Diameter of facing | Height Facing | Number of holes | Bolt hole diameter | Diameter of bolt circle | Kg / piece |
| DN | D | C2 | H1 | r | N2 | d1 | f1 | | I | K | |
| 10 | 75.0 | 12.0 | 20.0 | 4.0 | 25.0 | 35.0 | 2 | 4 | 11.0 | 50.0 | 0.3 |
| 15 | 80.0 | 12.0 | 20.0 | 4.0 | 30.0 | 40.0 | 2 | 4 | 11.0 | 55.0 | 0.4 |
| 20 | 90.0 | 14.0 | 24.0 | 4.0 | 40.0 | 50.0 | 2 | 4 | 11.0 | 65.0 | 0.6 |
| 25 | 100.0 | 14.0 | 24.0 | 4.0 | 50.0 | 60.0 | 2 | 4 | 11.0 | 75.0 | 0.7 |
| 32 | 120.0 | 14.0 | 26.0 | 6.0 | 60.0 | 70.0 | 2 | 4 | 14.0 | 90.0 | 1.0 |
| 40 | 130.0 | 14.0 | 26.0 | 6.0 | 70.0 | 80.0 | 3 | 4 | 14.0 | 100.0 | 1.2 |
| 50 | 140.0 | 14.0 | 28.0 | 6.0 | 80.0 | 90.0 | 3 | 4 | 14.0 | 110.0 | 1.3 |
| 65 | 160.0 | 14.0 | 32.0 | 6.0 | 100.0 | 110.0 | 3 | 4 | 14.0 | 130.0 | 1.8 |
| 80 | 190.0 | 16.0 | 34.0 | 8.0 | 110.0 | 128.0 | 3 | 4 | 18.0 | 150.0 | 2.8 |
| 100 | 210.0 | 16.0 | 40.0 | 8.0 | 130.0 | 148.0 | 3 | 4 | 18.0 | 170.0 | 3.0 |
| 125 | 240.0 | 18.0 | 44.0 | 8.0 | 160.0 | 178.0 | 3 | 8 | 18.0 | 200.0 | 4.3 |
| 150 | 265.0 | 18.0 | 44.0 | 10.0 | 185.0 | 202.0 | 3 | 8 | 18.0 | 225.0 | 4.6 |
| 200 | 320.0 | 20.0 | 44.0 | 10.0 | 240.0 | 258.0 | 3 | 8 | 18.0 | 280.0 | 7.0 |
| 250 | 375.0 | 22.0 | 44.0 | 12.0 | 295.0 | 312.0 | 3 | 12 | 18.0 | 335.0 | 9.1 |
| 300 | 440.0 | 22.0 | 44.0 | 12.0 | 355.0 | 365.0 | 4 | 12 | 22.0 | 395.0 | 12.4 |
| 350 | 490.0 | 22.0 | - | 12.0 | - | 415.0 | 4 | 12 | 22.0 | 445.0 | - |
| 400 | 540.0 | 22.0 | - | 12.0 | - | 465.0 | 4 | 16 | 22.0 | 495.0 | - |
| 450 | 595.0 | 22.0 | - | 12.0 | - | 520.0 | 4 | 16 | 22.0 | 550.0 | - |
| 500 | 645.0 | 24.0 | - | 12.0 | - | 570.0 | 4 | 20 | 22.0 | 600.0 | - |
| 600 | 755.0 | 30.0 | - | 12.0 | - | 670.0 | 5 | 20 | 26.0 | 705.0 | - |
| 700 | 860.0 | 30.0 | - | 12.0 | - | 775.0 | 5 | 24 | 26.0 | 810.0 | - |
| 800 | 975.0 | 30.0 | - | 12.0 | - | 880.0 | 5 | 24 | 30.0 | 920.0 | - |
| 900 | 1075.0 | 34.0 | - | 12.0 | - | 980.0 | 5 | 24 | 30.0 | 1020.0 | - |
| 1000 | 1175.0 | 38.0 | - | 16.0 | - | 1080.0 | 5 | 28 | 30.0 | 1120.0 | - |
| 1200 | 1405.0 | 42.0 | - | 16.0 | - | 1295.0 | 5 | 32 | 33.0 | 1340.0 | - |

> Weights are approximate.

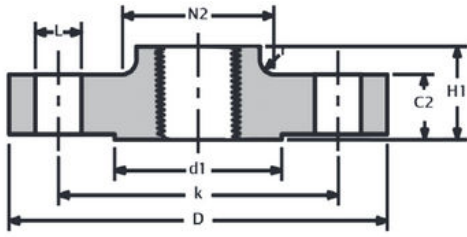

| PIPE | | FLANGE DATA | | | HUB DATA | | FLANGE FACING | | DRILLING DATA | | | WEIGHT |
|-------------------|------------------|-------------|--------------------|--------|----------|--------------------|---------------|-----------------|--------------------|-------------------------|------------|--------|
| Nominal pipe size | Outside diameter | Thickness | Length through hub | Radius | Diameter | Diameter of facing | Height Facing | Number of holes | Bolt hole diameter | Diameter of bolt circle | Kg / piece | |
| DN | D | C2 | H1 | r | N2 | d1 | f1 | | I | K | | |
| 10 | 90.0 | 16.0 | 22.0 | 4.0 | 30.0 | 40.0 | 2 | 4 | 14.0 | 60.0 | 0.7 | |
| 15 | 95.0 | 16.0 | 22.0 | 4.0 | 35.0 | 45.0 | 2 | 4 | 14.0 | 65.0 | 0.7 | |
| 20 | 105.0 | 18.0 | 26.0 | 4.0 | 45.0 | 58.0 | 2 | 4 | 14.0 | 75.0 | 1.0 | |
| 25 | 115.0 | 18.0 | 28.0 | 4.0 | 52.0 | 68.0 | 2 | 4 | 14.0 | 85.0 | 1.3 | |
| 32 | 140.0 | 18.0 | 30.0 | 6.0 | 60.0 | 78.0 | 2 | 4 | 18.0 | 100.0 | 1.8 | |
| 40 | 150.0 | 18.0 | 32.0 | 6.0 | 70.0 | 88.0 | 3 | 4 | 18.0 | 110.0 | 2.1 | |
| 50 | 165.0 | 18.0 | 28.0 | 6.0 | 84.0 | 102.0 | 3 | 4 | 18.0 | 125.0 | 2.4 | |
| 65 | 185.0 | 18.0 | 32.0 | 6.0 | 104.0 | 122.0 | 3 | 4 or 8 | 18.0 | 145.0 | 3.0 | |
| 80 | 200.0 | 20.0 | 34.0 | 6.0 | 118.0 | 138.0 | 3 | 8 | 18.0 | 160.0 | 3.8 | |
| 100 | 220.0 | 20.0 | 40.0 | 8.0 | 140.0 | 158.0 | 3 | 8 | 18.0 | 180.0 | 4.4 | |
| 125 | 250.0 | 22.0 | 44.0 | 8.0 | 168.0 | 188.0 | 3 | 8 | 18.0 | 210.0 | 6.1 | |
| 150 | 285.0 | 22.0 | 44.0 | 10.0 | 195.0 | 212.0 | 3 | 8 | 22.0 | 240.0 | 7.2 | |
| 200 | 340.0 | 24.0 | 44.0 | 10.0 | 246.0 | 268.0 | 3 | 8 | 22.0 | 295.0 | 10.1 | |
| 250 | 395.0 | 26.0 | 46.0 | 12.0 | 298.0 | 320.0 | 3 | 12 | 22.0 | 350.0 | 12.8 | |
| 300 | 445.0 | 26.0 | 46.0 | 12.0 | 350.0 | 370.0 | 4 | 12 | 22.0 | 400.0 | 14.5 | |
| 350 | 505.0 | 26.0 | 53.0 | 12.0 | 400.0 | 430.0 | 4 | 16 | 22.0 | 460.0 | 22.7 | |
| 400 | 565.0 | 26.0 | 57.0 | 12.0 | 456.0 | 482.0 | 4 | 16 | 26.0 | 515.0 | 28.0 | |
| 450 | 615.0 | 28.0 | 63.0 | 12.0 | 502.0 | 532.0 | 4 | 20 | 26.0 | 565.0 | 32.3 | |
| 500 | 670.0 | 28.0 | 67.0 | 12.0 | 559.0 | 585.0 | 4 | 20 | 26.0 | 620.0 | 38.7 | |
| 600 | 780.0 | 30.0 | 75.0 | 12.0 | 658.0 | 685.0 | 5 | 20 | 30.0 | 725.0 | 48.9 | |
| 700 | 895.0 | 35.0 | - | 12.0 | - | 800.0 | 5 | 24 | 30.0 | 840.0 | - | |
| 800 | 1015.0 | 38.0 | - | 12.0 | - | 905.0 | 5 | 24 | 33.0 | 950.0 | - | |
| 900 | 1115.0 | 38.0 | - | 12.0 | - | 1005.0 | 5 | 28 | 33.0 | 1050.0 | - | |
| 1000 | 1230.0 | 44.0 | - | 16.0 | - | 1110.0 | 5 | 28 | 36.0 | 1160.0 | - | |
| 1200 | 1455.0 | 55.0 | - | 16.0 | - | 1330.0 | 5 | 32 | 39.0 | 1380.0 | - | |

- > Weights are approximate.
- > DN65 available with 4 or 8 bolt holes.
- > DN50 - DN150 = PN16

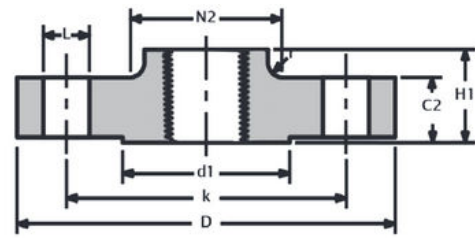

| PIPE | FLANGE DATA | | | HUB DATA | | FLANGE FACING | | DRILLING DATA | | | WEIGHT |
|-------------------|------------------|-----------|--------------------|----------|----------|--------------------|---------------|-----------------|--------------------|-------------------------|------------|
| Nominal pipe size | Outside diameter | Thickness | Length through hub | Radius | Diameter | Diameter of facing | Height Facing | Number of holes | Bolt hole diameter | Diameter of bolt circle | Kg / piece |
| DN | D | C2 | H1 | r | N2 | d1 | f1 | | I | K | |
| 10 | 90.0 | 16.0 | 22.0 | 4.0 | 30.0 | 40.0 | 2 | 4 | 14.0 | 60.0 | 0.7 |
| 15 | 95.0 | 16.0 | 22.0 | 4.0 | 35.0 | 45.0 | 2 | 4 | 14.0 | 65.0 | 0.7 |
| 20 | 105.0 | 18.0 | 26.0 | 4.0 | 45.0 | 58.0 | 2 | 4 | 14.0 | 75.0 | 1.0 |
| 25 | 115.0 | 18.0 | 28.0 | 4.0 | 52.0 | 68.0 | 2 | 4 | 14.0 | 85.0 | 1.3 |
| 32 | 140.0 | 18.0 | 30.0 | 6.0 | 60.0 | 78.0 | 2 | 4 | 18.0 | 100.0 | 1.8 |
| 40 | 150.0 | 18.0 | 32.0 | 6.0 | 70.0 | 88.0 | 3 | 4 | 18.0 | 110.0 | 2.1 |
| 50 | 165.0 | 18.0 | 28.0 | 6.0 | 84.0 | 102.0 | 3 | 4 | 18.0 | 125.0 | 2.4 |
| 65 | 185.0 | 18.0 | 32.0 | 6.0 | 104.0 | 122.0 | 3 | 4 or 8 | 18.0 | 145.0 | 3.0 |
| 80 | 200.0 | 20.0 | 34.0 | 6.0 | 118.0 | 138.0 | 3 | 8 | 18.0 | 160.0 | 3.8 |
| 100 | 220.0 | 20.0 | 40.0 | 8.0 | 140.0 | 158.0 | 3 | 8 | 18.0 | 180.0 | 4.4 |
| 125 | 250.0 | 22.0 | 44.0 | 8.0 | 168.0 | 188.0 | 3 | 8 | 18.0 | 210.0 | 6.1 |
| 150 | 285.0 | 22.0 | 44.0 | 10.0 | 195.0 | 212.0 | 3 | 8 | 22.0 | 240.0 | 7.2 |
| 200 | 340.0 | 24.0 | 44.0 | 10.0 | 246.0 | 268.0 | 3 | 12 | 22.0 | 295.0 | 9.8 |
| 250 | 405.0 | 26.0 | 46.0 | 12.0 | 298.0 | 320.0 | 3 | 12 | 26.0 | 355.0 | 13.6 |
| 300 | 460.0 | 28.0 | 46.0 | 12.0 | 350.0 | 378.0 | 4 | 12 | 26.0 | 410.0 | 17.2 |
| 350 | 520.0 | 30.0 | 57.0 | 12.0 | 400.0 | 438.0 | 4 | 16 | 26.0 | 470.0 | 27.9 |
| 400 | 580.0 | 32.0 | 63.0 | 12.0 | 456.0 | 490.0 | 4 | 16 | 30.0 | 525.0 | 35.7 |
| 450 | 640.0 | 34.0 | 68.0 | 12.0 | 502.0 | 550.0 | 4 | 20 | 30.0 | 585.0 | 45.0 |
| 500 | 715.0 | 36.0 | 73.0 | 12.0 | 559.0 | 610.0 | 4 | 20 | 33.0 | 650.0 | 60.4 |
| 600 | 840.0 | 40.0 | 83.0 | 12.0 | 658.0 | 725.0 | 5 | 20 | 36.0 | 770.0 | 94.0 |
| 700 | 910.0 | 40.0 | 83.0 | 12.0 | 760.0 | 795.0 | 5 | 24 | 36.0 | 840.0 | - |
| 800 | 1025.0 | 41.0 | 90.0 | 12.0 | 864.0 | 900.0 | 5 | 24 | 39.0 | 950.0 | - |
| 900 | 1125.0 | 48.0 | 94.0 | 12.0 | 968.0 | 1000.0 | 5 | 28 | 39.0 | 1050.0 | - |
| 1000 | 1255.0 | 59.0 | 100.0 | 16.0 | 1072.0 | 1115.0 | 5 | 28 | 42.0 | 1170.0 | - |
| 1200 | 1485.0 | 78.0 | - | 16.0 | - | 1330.0 | 5 | 32 | 48.0 | 1390.0 | - |

- > Weights are approximate.
- > DN65 available with 4 or 8 bolt holes.
- > DN10 - DN40 = PN40

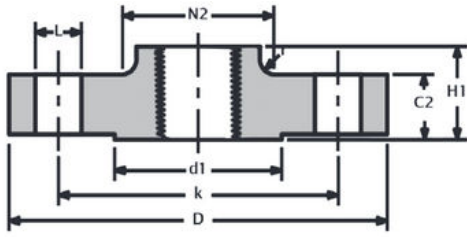

| PIPE | FLANGE DATA | | | HUB DATA | | FLANGE FACING | | DRILLING DATA | | | WEIGHT |
|-------------------|------------------|-----------|--------------------|----------|----------|--------------------|---------------|-----------------|--------------------|-------------------------|------------|
| Nominal pipe size | Outside diameter | Thickness | Length through hub | Radius | Diameter | Diameter of facing | Height Facing | Number of holes | Bolt hole diameter | Diameter of bolt circle | Kg / piece |
| DN | D | C2 | H1 | r | N2 | d1 | f1 | | I | K | |
| 10 | 90.0 | 16.0 | 22.0 | 4.0 | 30.0 | 40.0 | 2 | 4 | 14.0 | 60.0 | 0,6 |
| 15 | 95.0 | 16.0 | 22.0 | 4.0 | 35.0 | 45.0 | 2 | 4 | 14.0 | 65.0 | 0.7 |
| 20 | 105.0 | 18.0 | 26.0 | 4.0 | 45.0 | 58.0 | 2 | 4 | 14.0 | 75.0 | 1.0 |
| 25 | 115.0 | 18.0 | 28.0 | 4.0 | 52.0 | 68.0 | 2 | 4 | 14.0 | 85.0 | 1.3 |
| 32 | 140.0 | 18.0 | 30.0 | 6.0 | 60.0 | 78.0 | 2 | 4 | 18.0 | 100.0 | 1.8 |
| 40 | 150.0 | 18.0 | 32.0 | 6.0 | 70.0 | 88.0 | 3 | 4 | 18.0 | 110.0 | 2.1 |
| 50 | 165.0 | 20.0 | 34.0 | 6.0 | 84.0 | 102.0 | 3 | 4 | 18.0 | 125.0 | 2.7 |
| 65 | 185.0 | 22.0 | 38.0 | 6.0 | 104.0 | 122.0 | 3 | 8 | 18.0 | 145.0 | 3.7 |
| 80 | 200.0 | 24.0 | 40.0 | 8.0 | 118.0 | 138.0 | 3 | 8 | 18.0 | 160.0 | 4.6 |
| 100 | 235.0 | 24.0 | 44.0 | 8.0 | 145.0 | 162.0 | 3 | 8 | 22.0 | 190.0 | 6.1 |
| 125 | 270.0 | 26.0 | 48.0 | 8.0 | 170.0 | 188.0 | 3 | 8 | 26.0 | 220.0 | 8.2 |
| 150 | 300.0 | 28.0 | 52.0 | 10.0 | 200.0 | 218.0 | 3 | 8 | 26.0 | 250.0 | 10.6 |
| 200 | 360.0 | 30.0 | 52.0 | 10.0 | 256.0 | 278.0 | 3 | 12 | 26.0 | 310.0 | 14.9 |
| 250 | 425.0 | 32.0 | 60.0 | 12.0 | 310.0 | 335.0 | 3 | 12 | 30.0 | 370.0 | 20.9 |
| 300 | 485.0 | 34.0 | 67.0 | 12.0 | 364.0 | 395.0 | 4 | 16 | 30.0 | 430.0 | 27.3 |
| 350 | 555.0 | 38.0 | 72.0 | 12.0 | 418.0 | 450.0 | 4 | 16 | 33.0 | 490.0 | 45.1 |
| 400 | 620.0 | 40.0 | 78.0 | 12.0 | 472.0 | 505.0 | 4 | 16 | 36.0 | 550.0 | 57.7 |
| 450 | 670.0 | 46.0 | 84.0 | 12.0 | 520.0 | 555.0 | 4 | 20 | 36.0 | 600.0 | 69.6 |
| 500 | 730.0 | 48.0 | 90.0 | 12.0 | 580.0 | 615.0 | 4 | 20 | 36.0 | 660.0 | 87.0 |
| 600 | 845.0 | 48.0 | 100.0 | 12.0 | 684.0 | 720.0 | 5 | 20 | 39.0 | 770.0 | 111.0 |
| 700 | 960.0 | 50.0 | - | 12.0 | - | 820.0 | 5 | 24 | 42.0 | 875.0 | - |
| 800 | 1085.0 | 53.0 | - | 12.0 | - | 930.0 | 5 | 24 | 48.0 | 990.0 | - |
| 900 | 1185.0 | 57.0 | - | 12.0 | - | 1030.0 | 5 | 28 | 48.0 | 1090.0 | - |
| 1000 | 1320.0 | 63.0 | - | 16.0 | - | 1140.0 | 5 | 28 | 56.0 | 1210.0 | - |

> Weights are approximate.
> DN10 - DN150 = PN40

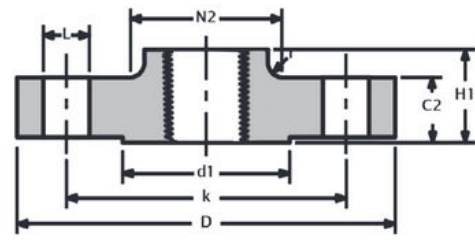

| PIPE | FLANGE DATA | | | HUB DATA | | FLANGE FACING | | DRILLING DATA | | | WEIGHT |
|-------------------|------------------|-----------|--------------------|----------|----------|--------------------|---------------|-----------------|--------------------|-------------------------|------------|
| Nominal pipe size | Outside diameter | Thickness | Length through hub | Radius | Diameter | Diameter of facing | Height Facing | Number of holes | Bolt hole diameter | Diameter of bolt circle | Kg / piece |
| DN | D | C2 | H1 | r | N2 | d1 | f1 | | I | K | |
| 10 | 90.0 | 16.0 | 22.0 | 4.0 | 30.0 | 40.0 | 2 | 4 | 14.0 | 60.0 | 0,6 |
| 15 | 95.0 | 16.0 | 22.0 | 4.0 | 35.0 | 45.0 | 2 | 4 | 14.0 | 65.0 | 0.7 |
| 20 | 105.0 | 18.0 | 26.0 | 4.0 | 45.0 | 58.0 | 2 | 4 | 14.0 | 75.0 | 1.0 |
| 25 | 115.0 | 18.0 | 28.0 | 4.0 | 52.0 | 68.0 | 2 | 4 | 14.0 | 85.0 | 1.3 |
| 32 | 140.0 | 18.0 | 30.0 | 6.0 | 60.0 | 78.0 | 2 | 4 | 18.0 | 100.0 | 1.8 |
| 40 | 150.0 | 18.0 | 32.0 | 6.0 | 70.0 | 88.0 | 3 | 4 | 18.0 | 110.0 | 2.1 |
| 50 | 165.0 | 20.0 | 34.0 | 6.0 | 84.0 | 102.0 | 3 | 4 | 18.0 | 125.0 | 2.7 |
| 65 | 185.0 | 22.0 | 38.0 | 6.0 | 104.0 | 122.0 | 3 | 8 | 18.0 | 145.0 | 3.7 |
| 80 | 200.0 | 24.0 | 40.0 | 8.0 | 118.0 | 138.0 | 3 | 8 | 18.0 | 160.0 | 4.6 |
| 100 | 235.0 | 24.0 | 44.0 | 8.0 | 145.0 | 162.0 | 3 | 8 | 22.0 | 190.0 | 6.1 |
| 125 | 270.0 | 26.0 | 48.0 | 8.0 | 170.0 | 188.0 | 3 | 8 | 26.0 | 220.0 | 8.2 |
| 150 | 300.0 | 28.0 | 52.0 | 10.0 | 200.0 | 218.0 | 3 | 8 | 26.0 | 250.0 | 10.6 |
| 200 | 375.0 | 34.0 | 52.0 | 10.0 | 260.0 | 285.0 | 3 | 12 | 30.0 | 320.0 | 18.3 |
| 250 | 450.0 | 38.0 | 60.0 | 12.0 | 312.0 | 345.0 | 3 | 12 | 33.0 | 385.0 | 28.3 |
| 300 | 515.0 | 42.0 | 67.0 | 12.0 | 380.0 | 410.0 | 4 | 16 | 33.0 | 450.0 | 40.4 |
| 350 | 580.0 | 46.0 | 72.0 | 12.0 | 424.0 | 465.0 | 4 | 16 | 36.0 | 510.0 | 58.8 |
| 400 | 660.0 | 50.0 | 78.0 | 12.0 | 478.0 | 535.0 | 4 | 16 | 39.0 | 585.0 | 82.1 |
| 450 | 685.0 | 57.0 | 84.0 | 12.0 | 522.0 | 560.0 | 4 | 20 | 39.0 | 610.0 | 86.2 |
| 500 | 755.0 | 57.0 | 90.0 | 12.0 | 576.0 | 615.0 | 4 | 20 | 42.0 | 670.0 | 105.0 |
| 600 | 890.0 | 72.0 | 100.0 | 12.0 | 686.0 | 735.0 | 5 | 20 | 48.0 | 795.0 | 172.0 |

> Weights are approximate.
> DN10 - DN150 = PN40

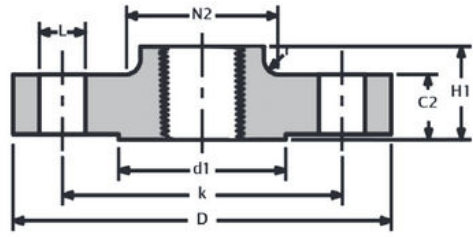

| PIPE | FLANGE DATA | | | HUB DATA | | FLANGE FACING | | DRILLING DATA | | | WEIGHT |
|-------------------|------------------|-----------|--------------------|----------|----------|--------------------|---------------|-----------------|--------------------|-------------------------|------------|
| Nominal pipe size | Outside diameter | Thickness | Length through hub | Radius | Diameter | Diameter of facing | Height Facing | Number of holes | Bolt hole diameter | Diameter of bolt circle | Kg / piece |
| DN | D | C2 | H1 | r | N2 | d1 | f1 | | I | K | |
| 10 | 100.0 | 20.0 | 28.0 | 4.0 | 40.0 | 40.0 | 2 | 4 | 14.0 | 70.0 | 1.1 |
| 15 | 105.0 | 20.0 | 28.0 | 4.0 | 43.0 | 45.0 | 2 | 4 | 14.0 | 75.0 | 1.2 |
| 20 | 130.0 | 22.0 | 30.0 | 4.0 | 52.0 | 58.0 | 2 | 4 | 18.0 | 90.0 | 2.0 |
| 25 | 140.0 | 24.0 | 32.0 | 4.0 | 60.0 | 68.0 | 2 | 4 | 18.0 | 100.0 | 2.5 |
| 32 | 155.0 | 24.0 | 32.0 | 6.0 | 68.0 | 78.0 | 2 | 4 | 22.0 | 110.0 | 3.0 |
| 40 | 170.0 | 26.0 | 34.0 | 6.0 | 80.0 | 88.0 | 3 | 4 | 22.0 | 125.0 | 3.8 |
| 50 | 180.0 | 26.0 | 36.0 | 6.0 | 90.0 | 102.0 | 3 | 4 | 22.0 | 135.0 | 4.2 |
| 65 | 205.0 | 26.0 | 40.0 | 6.0 | 112.0 | 122.0 | 3 | 8 | 22.0 | 160.0 | 5.3 |
| 80 | 215.0 | 28.0 | 44.0 | 8.0 | 125.0 | 138.0 | 3 | 8 | 22.0 | 170.0 | 6.3 |
| 100 | 250.0 | 30.0 | 52.0 | 8.0 | 152.0 | 162.0 | 3 | 8 | 26.0 | 200.0 | 8.8 |
| 125 | 295.0 | 34.0 | 56.0 | 8.0 | 185.0 | 188.0 | 3 | 8 | 30.0 | 240.0 | 13.6 |
| 150 | 345.0 | 36.0 | 60.0 | 10.0 | 215.0 | 218.0 | 3 | 8 | 33.0 | 280.0 | 19.5 |
| 200 | 415.0 | 42.0 | - | 10.0 | - | 285.0 | 3 | 12 | 36.0 | 345.0 | - |
| 250 | 470.0 | 46.0 | - | 12.0 | - | 345.0 | 3 | 12 | 36.0 | 400.0 | - |
| 300 | 530.0 | 52.0 | - | 12.0 | - | 410.0 | 4 | 16 | 36.0 | 460.0 | - |
| 350 | 600.0 | 56.0 | - | 12.0 | - | 465.0 | 4 | 16 | 39.0 | 525.0 | - |
| 400 | 670.0 | 60.0 | - | 12.0 | - | 535.0 | 4 | 16 | 42.0 | 585.0 | - |

- > Weights are approximate.
- > DN10 - DN40 = PN100

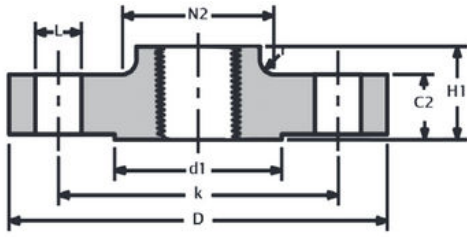

| PIPE | FLANGE DATA | | | HUB DATA | | FLANGE FACING | | DRILLING DATA | | | WEIGHT |
|-------------------|------------------|-----------|--------------------|----------|----------|--------------------|---------------|-----------------|--------------------|-------------------------|------------|
| Nominal pipe size | Outside diameter | Thickness | Length through hub | Radius | Diameter | Diameter of facing | Height Facing | Number of holes | Bolt hole diameter | Diameter of bolt circle | Kg / piece |
| DN | D | C2 | H1 | r | N2 | d1 | f1 | | I | K | |
| 10 | 100.0 | 20.0 | 28.0 | 4.0 | 40.0 | 40.0 | 2 | 4 | 14.0 | 70.0 | 1.1 |
| 15 | 105.0 | 20.0 | 28.0 | 4.0 | 43.0 | 45.0 | 2 | 4 | 14.0 | 75.0 | 1.2 |
| 20 | 130.0 | 22.0 | 30.0 | 4.0 | 52.0 | 58.0 | 2 | 4 | 18.0 | 90.0 | 2.0 |
| 25 | 140.0 | 24.0 | 32.0 | 4.0 | 60.0 | 68.0 | 2 | 4 | 18.0 | 100.0 | 2.5 |
| 32 | 155.0 | 24.0 | 32.0 | 6.0 | 68.0 | 78.0 | 2 | 4 | 22.0 | 110.0 | 3.0 |
| 40 | 170.0 | 26.0 | 34.0 | 6.0 | 80.0 | 88.0 | 3 | 4 | 22.0 | 125.0 | 3.8 |
| 50 | 195.0 | 28.0 | 36.0 | 6.0 | 95.0 | 102.0 | 3 | 4 | 26.0 | 145.0 | 5.3 |
| 65 | 220.0 | 30.0 | 40.0 | 6.0 | 118.0 | 122.0 | 3 | 8 | 26.0 | 170.0 | 6.8 |
| 80 | 230.0 | 32.0 | 44.0 | 8.0 | 130.0 | 138.0 | 3 | 8 | 26.0 | 180.0 | 7.9 |
| 100 | 265.0 | 36.0 | 52.0 | 8.0 | 158.0 | 162.0 | 3 | 8 | 30.0 | 210.0 | 11.5 |
| 125 | 315.0 | 40.0 | 56.0 | 8.0 | 188.0 | 188.0 | 3 | 8 | 33.0 | 250.0 | 17.9 |
| 150 | 355.0 | 44.0 | 60.0 | 10.0 | 225.0 | 218.0 | 3 | 12 | 33.0 | 290.0 | 23.8 |
| 200 | 430.0 | 52.0 | - | 10.0 | - | 285.0 | 3 | 12 | 36.0 | 360.0 | - |
| 250 | 505.0 | 60.0 | - | 12.0 | - | 345.0 | 3 | 12 | 39.0 | 430.0 | - |
| 300 | 585.0 | 68.0 | - | 12.0 | - | 410.0 | 4 | 16 | 42.0 | 500.0 | - |
| 350 | 655.0 | 74.0 | - | 12.0 | - | 465.0 | 4 | 16 | 48.0 | 560.0 | - |

- > Weights are approximate.
- > DN65 available with 4 or 8 bolt holes.
- > DN10 - DN40 = PN100

FLANGE FACING TYPES

EN 1092-1



| | |
|--------|---------------|
| TYPE A | FLAT FACE |
| TYPE B | RAISED FACE |
| TYPE C | TONGUE |
| TYPE D | GROOVE |
| TYPE E | SPIGOT |
| TYPE F | RECESS |
| TYPE G | O-RING SPIGOT |
| TYPE H | O-RING GROOVE |

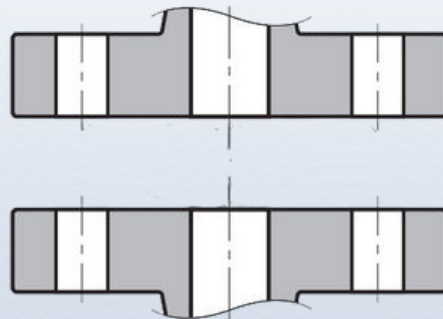

TYPE A - FLAT FACE

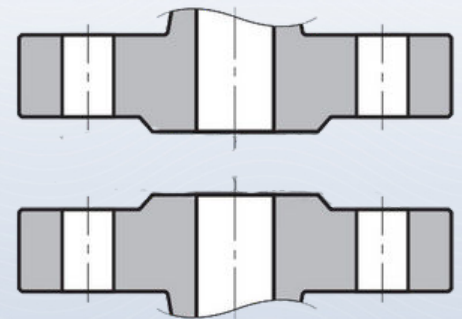

TYPE B - RAISED FACE

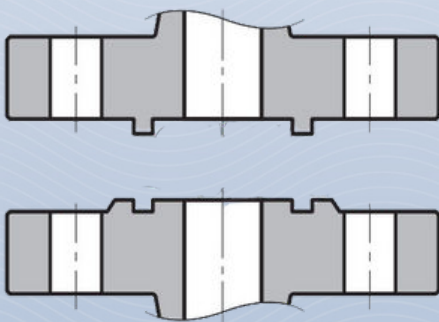

TYPE C AND D -
TONGUE AND GROOVE FACE

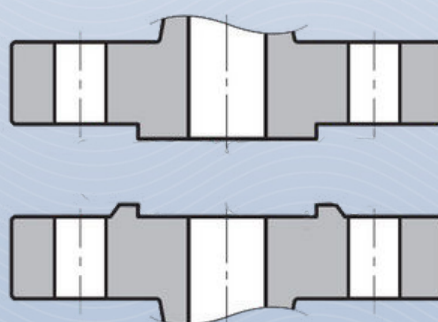

TYPE E AND F -
SPIGOT AND RECESS FACE

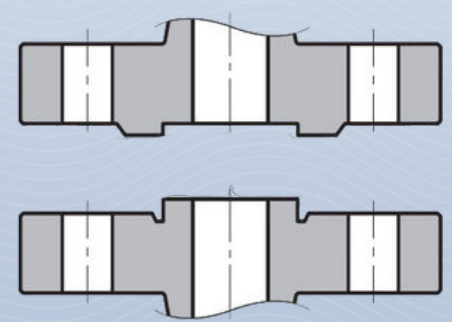

TYPE G AND O -
O-RING SPIGOT
AND
O- GROOVE FACE

| FACING TYPES | METHODE OF MACHINING | RADIUS OF TOOL NOSE MM | RA μm | | RZ μm | |
|-----------------|----------------------|------------------------|------------------|------|------------------|------|
| | | min. | min. | max. | min. | max. |
| A, B1 b, E, F | Turning c | 1.0 | 3.2 | 12.5 | 12.5 | 50 |
| B2b, C, D, G, H | Turning c | - | 0.8 | 3.2 | 3.2 | 12.5 |

For certain applications, e.g. low temperatures gases, it may be necessary to stipulate closer controle to the surface finish.

| | |
|----|--|
| A | Ra and Rz are defined in EN ISO 4287 |
| B | Types B1 and B2 are raised face (type B) flanges with different specified surface roughness values. |
| B1 | Standard facing for all PN numbers. |
| B2 | Only if agreed between the purchser and the flange manufacturer. |
| C | The term "turning" includes any method of machine operation producing either serrated concentric or serrated spiral grooves. |